

TM Site: Description:

P-17-024E	ROUTE 1, EB, 0.5 km WEST OF MCCALLUM ROAD, ABBOTSFORD
P-17-024W	ROUTE 1, WB, 0.5 km WEST OF MCCALLUM ROAD, ABBOTSFORD
P-17-025E	ROUTE 1, EB, 0.5 km WEST OF MCCALLUM ROAD, ABBOTSFORD
P-17-025W	ROUTE 1, WB, 0.5 km WEST OF MCCALLUM ROAD, ABBOTSFORD

Station: 65560P
Name: MCCALLUM I/C
Survey:

- ▲ - Short Count Post
- - Loops
- - Cabinet
- - Junction Box
- - Traffic Measurement Site
- ① - Channels
- A - Detectors

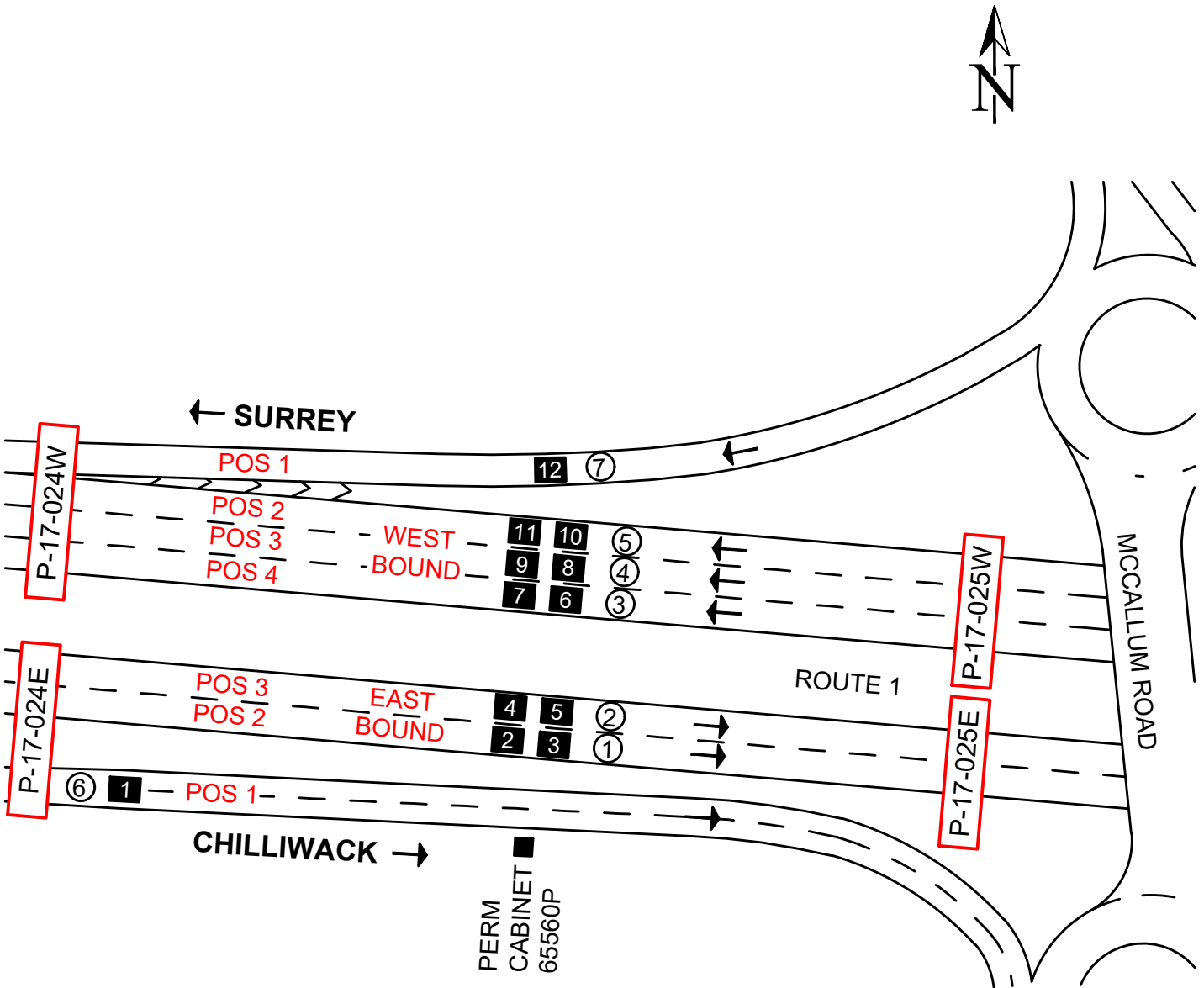

NOT TO SCALE