

TM Site:

Description:

42-015EW

ROUTE 16, 0.7 km WEST OF ROUTE 97, PRINCE GEORGE

Station: 58810S

58811S

Survey: 5881

▲ - Short Count Post

■ - Loops

■ - Junction Box

□ - TRADAS Traffic Measurement Site

① - Channels

A - Detectors

PHOTOLOG

YEAR: 2000

HIGHWAY: H16R

IMAGE NUMBER: 35333

SHOWS LOOPS:



YES



NO

GPS: N 53° 53'27.5"

W 122° 46'2.4"

±200 metres

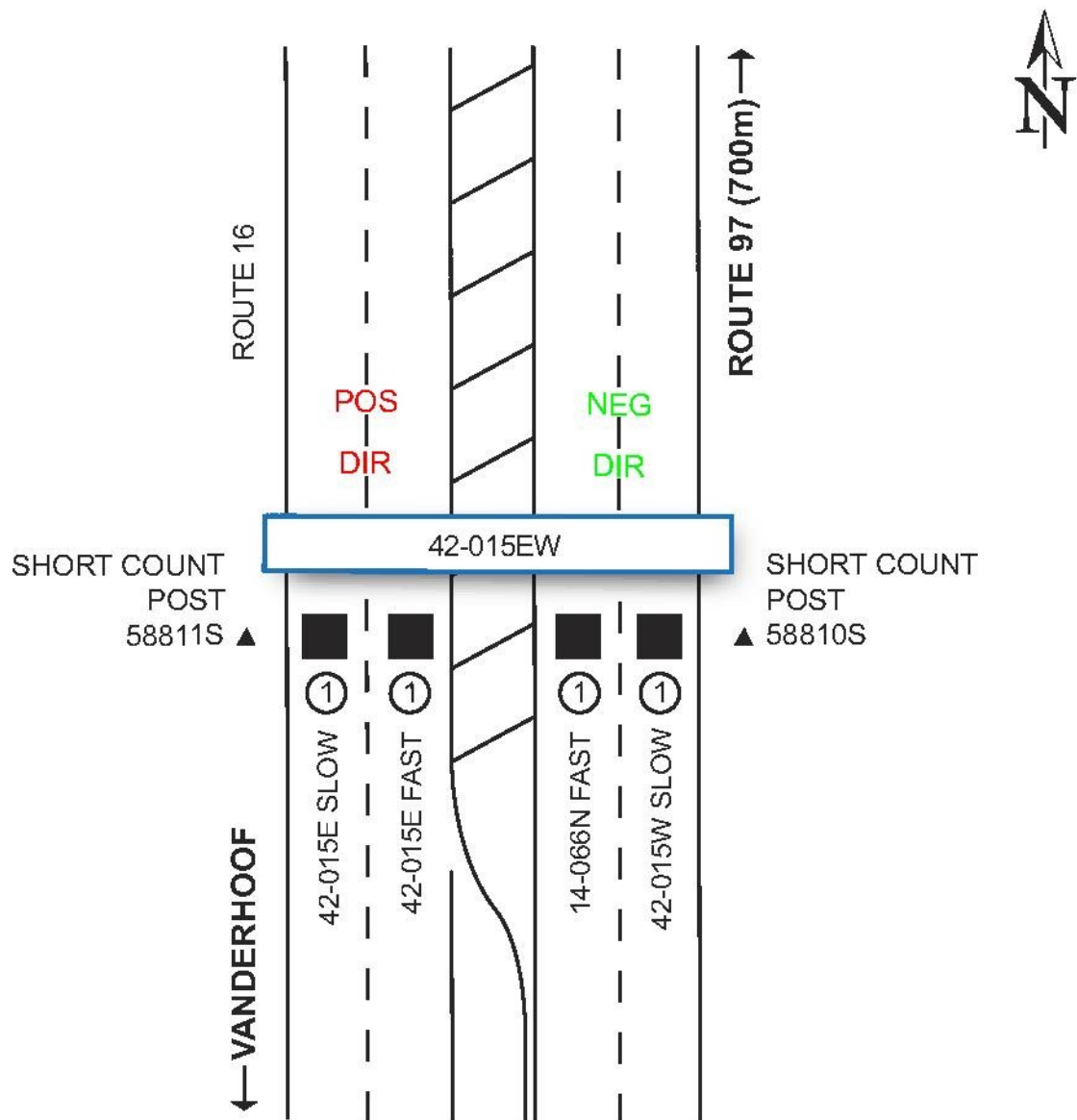

NOT TO SCALE

Highway Planning Branch
TRANHighway Planning@gov.bc.ca

Revised Date: February / 2007
Version 1-A