

**TM Site:**

**Description:**

12-034NS

ROUTE 1, AT THE NORTH END OF THE GEORGE PEARSON BRIDGE, NANAIMO

**Station:** 55540S

55541S

**Survey:** 5554

▲ - Short Count Post

□ - TRADAS Traffic Measurement Site

■ - Loops

① - Channels

■ - Junction Box

A - Detectors

**PHOTOLOG**

YEAR: 1999

HIGHWAY: H1

IMAGE NUMBER: 11299

SHOWS LOOPS:



YES



NO

GPS: N 49° 10'18.7"

W 123° 56'30.6"

± 200 metres

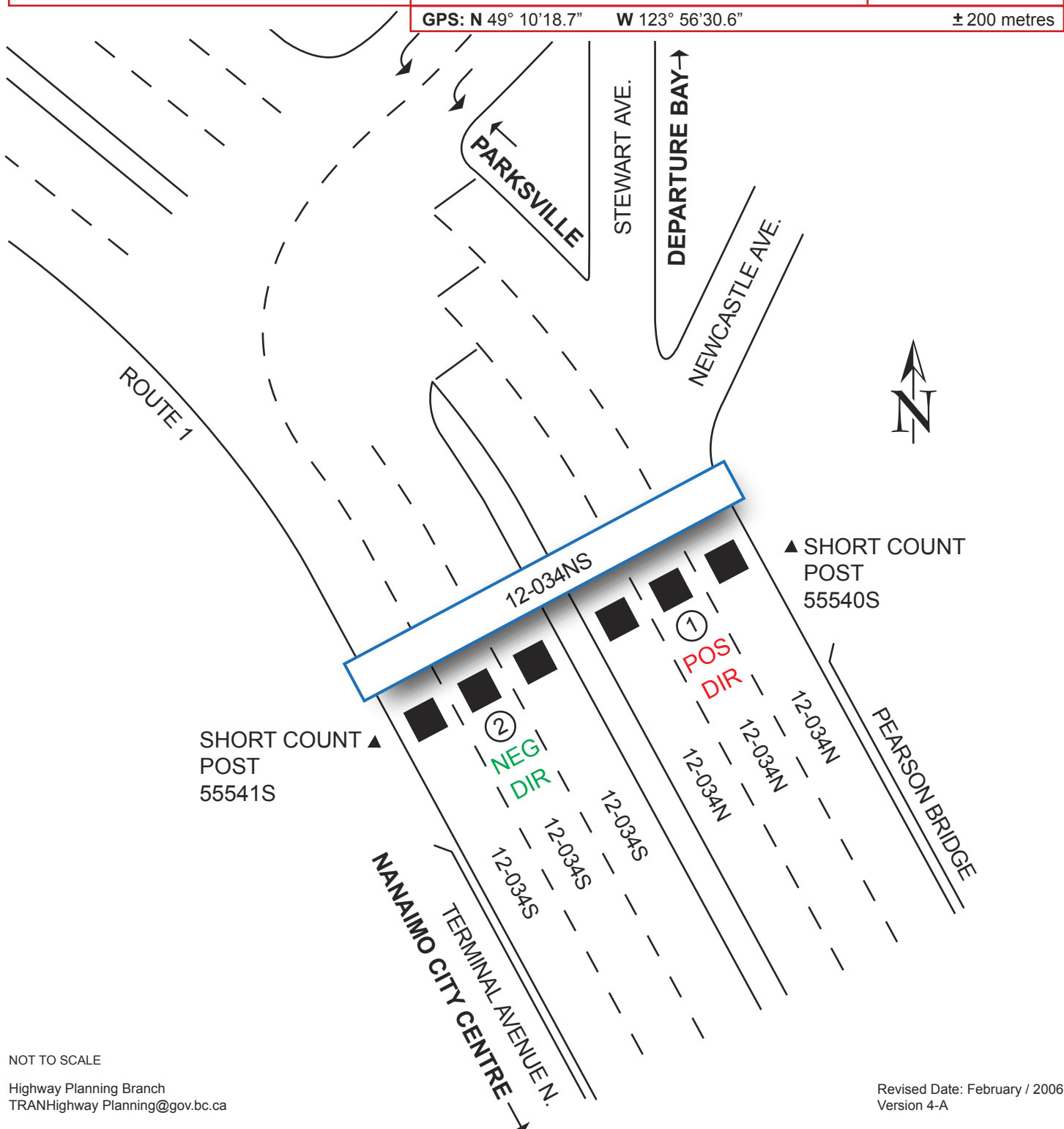

NOT TO SCALE

Highway Planning Branch  
TRANHighway Planning@gov.bc.ca

Revised Date: February / 2006  
Version 4-A