

TM Site: Description:

14-051N ROUTE 19, (INLAND ISLAND HWY) NB THRU TRAFFIC, JUST NORTH OF ALBERNI HWY, PARKSVILLE (COMPOSITE)
14-051S ROUTE 19, (INLAND ISLAND HWY) SB THRU TRAFFIC, JUST NORTH OF ALBERNI HWY, PARKSVILLE (COMPOSITE)

Station: 51640S
51642S
Survey: 5164

- ▲ - Short Count Post
- - Loops
- - Junction Box
- - TRADAS Traffic Measurement Site
- ① - Channels
- A - Detectors

PHOTOLOG
 YEAR: 2000
 HIGHWAY: H19
 IMAGE NUMBER: 5109
 SHOWS LOOPS:
 YES NO

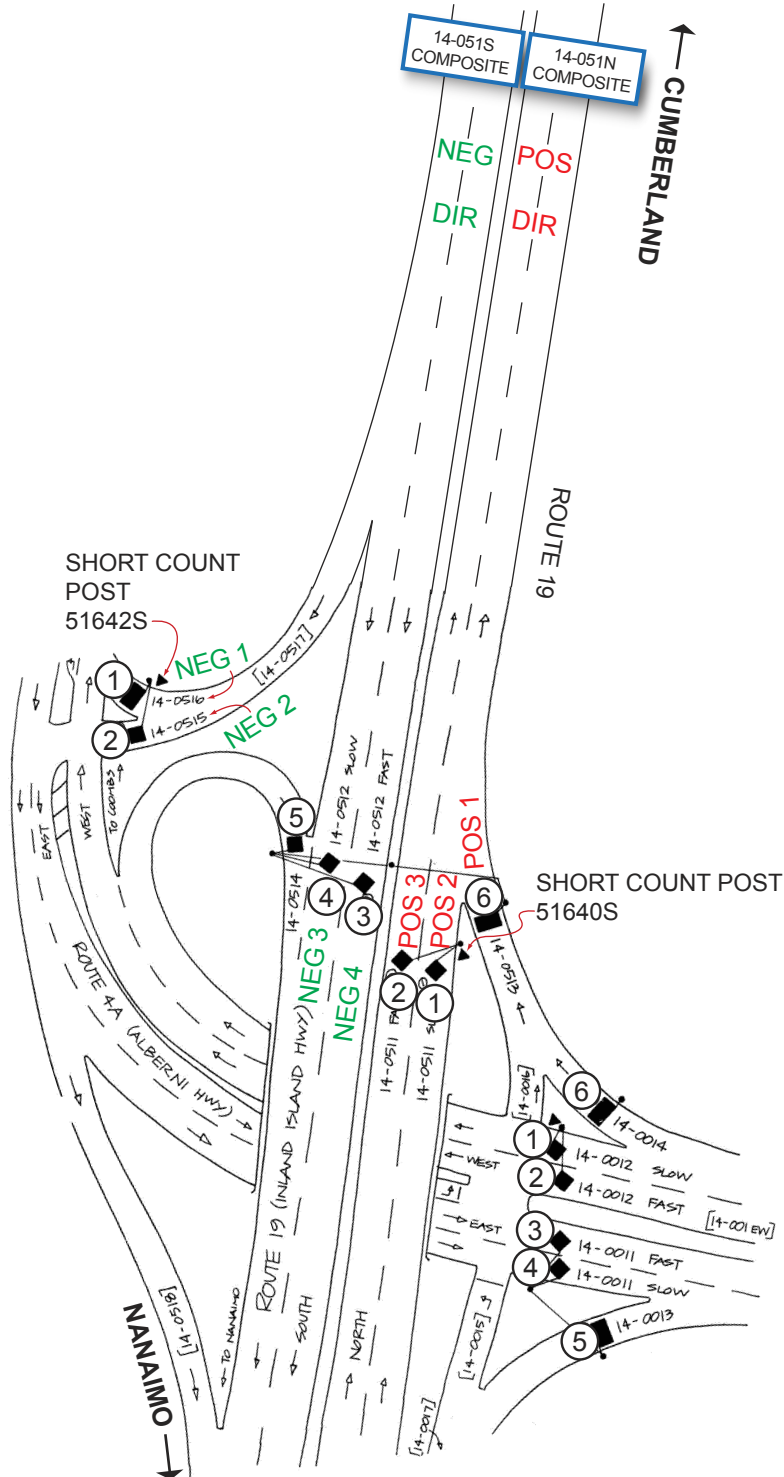

NOT TO SCALE

Highway Planning Branch
 TRANHighway Planning@gov.bc.ca

Revised Date: February / 2006
 Version 3-A