

**TM Site:**

**Description:**

15-046E  
15-046W  
15-087W

ROUTE 1/99, 08 km E. OF RTE 99, WEST VANCOUVER (COMP)  
ROUTE 1/99, 08 km E. OF RTE 99, WEST VANCOUVER (COMP)  
ROUTE 1, ACCESS TO HORSESHOE BAY FERRY TERMINAL, WEST VANCOUVER (COMP)

**Station:** 51200S  
51201S  
**Survey:** 5120

- ▲ - Short Count Post
- - Loops
- - Junction Box
- - TRADAS Traffic Measurement Site
- ① - Channels
- A - Detectors

**PHOTOLOG**  
YEAR: 2000  
HIGHWAY: H1  
IMAGE NUMBER: -  
SHOWS LOOPS:  
 YES  NO

GPS: N 49° 21'55.3" W 123° 30'.8" ± 200 metres

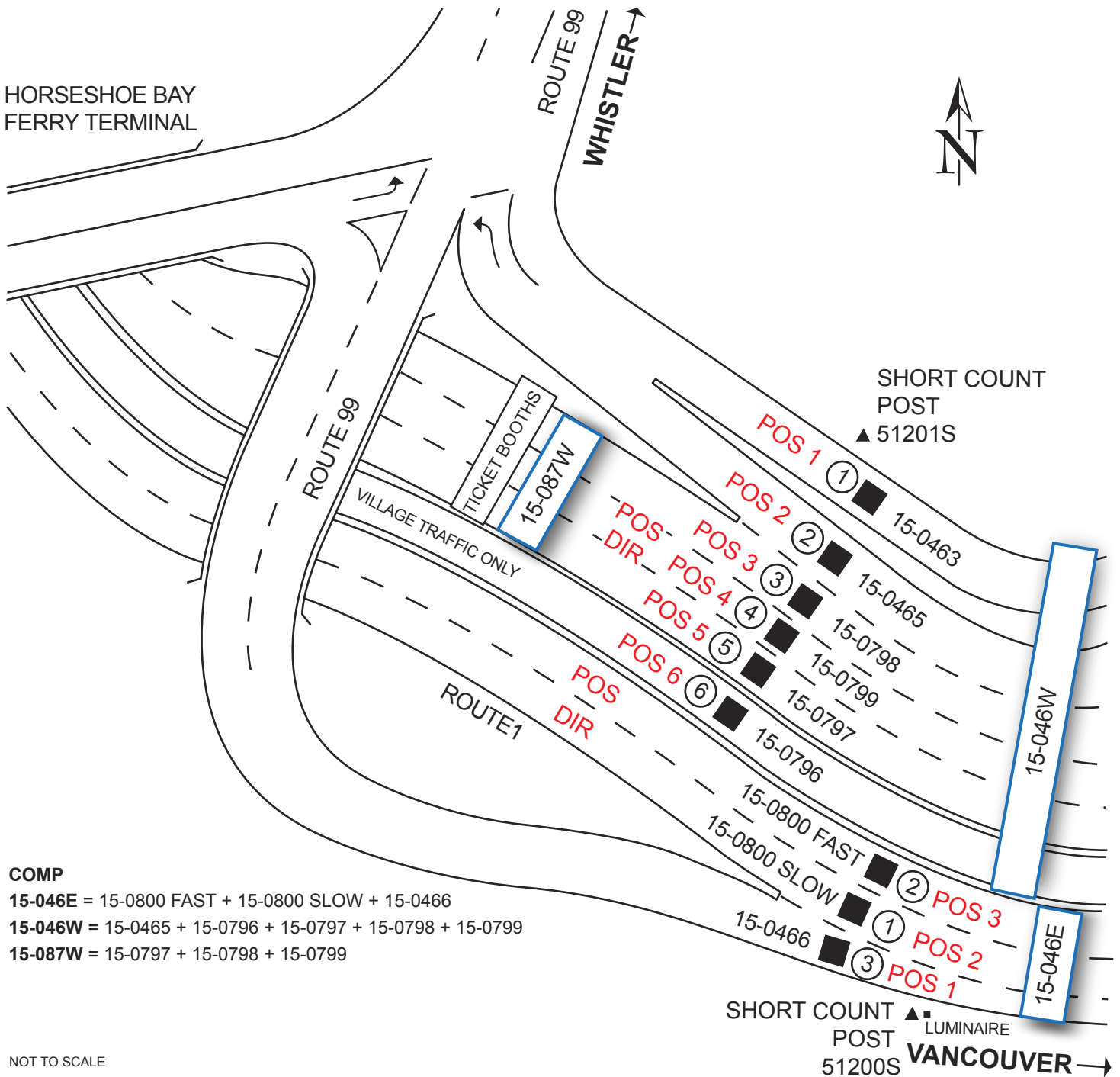

**COMP**

15-046E = 15-0800 FAST + 15-0800 SLOW + 15-0466  
15-046W = 15-0465 + 15-0796 + 15-0797 + 15-0798 + 15-0799  
15-087W = 15-0797 + 15-0798 + 15-0799

NOT TO SCALE

Highway Planning Branch  
TRANHighway.Planning@gov.bc.ca

SHORT COUNT POST LUMINAIRE  
51200S VANCOUVER →

Revised Date: May / 2006  
Version 1-A