

TM Site:

Description:

P-67-10NS

ROUTE 99, JUST SOUTH OF WESTMINSTER HIGHWAY, RICHMOND

P-67-8NS

ROUTE 99, JUST SOUTH OF WESTMINSTER HIGHWAY, RICHMOND

P-67-9

RAMP, FROM ROUTE 99 NB TO WESTMINSTER HIGHWAY WB, RICHMOND

P-68-1

RAMP, FROM ROUTE 99 NB TO WESTMINSTER HIGHWAY EB, RICHMOND

Station: 50690P

Name: WESTMINSTER NORTH

Survey: 5069

▲ - Short Count Post

■ - Loops

■ - Cabinet

■ - Junction Box

□ - Traffic Measurement Site

① - Channels

A - Detectors

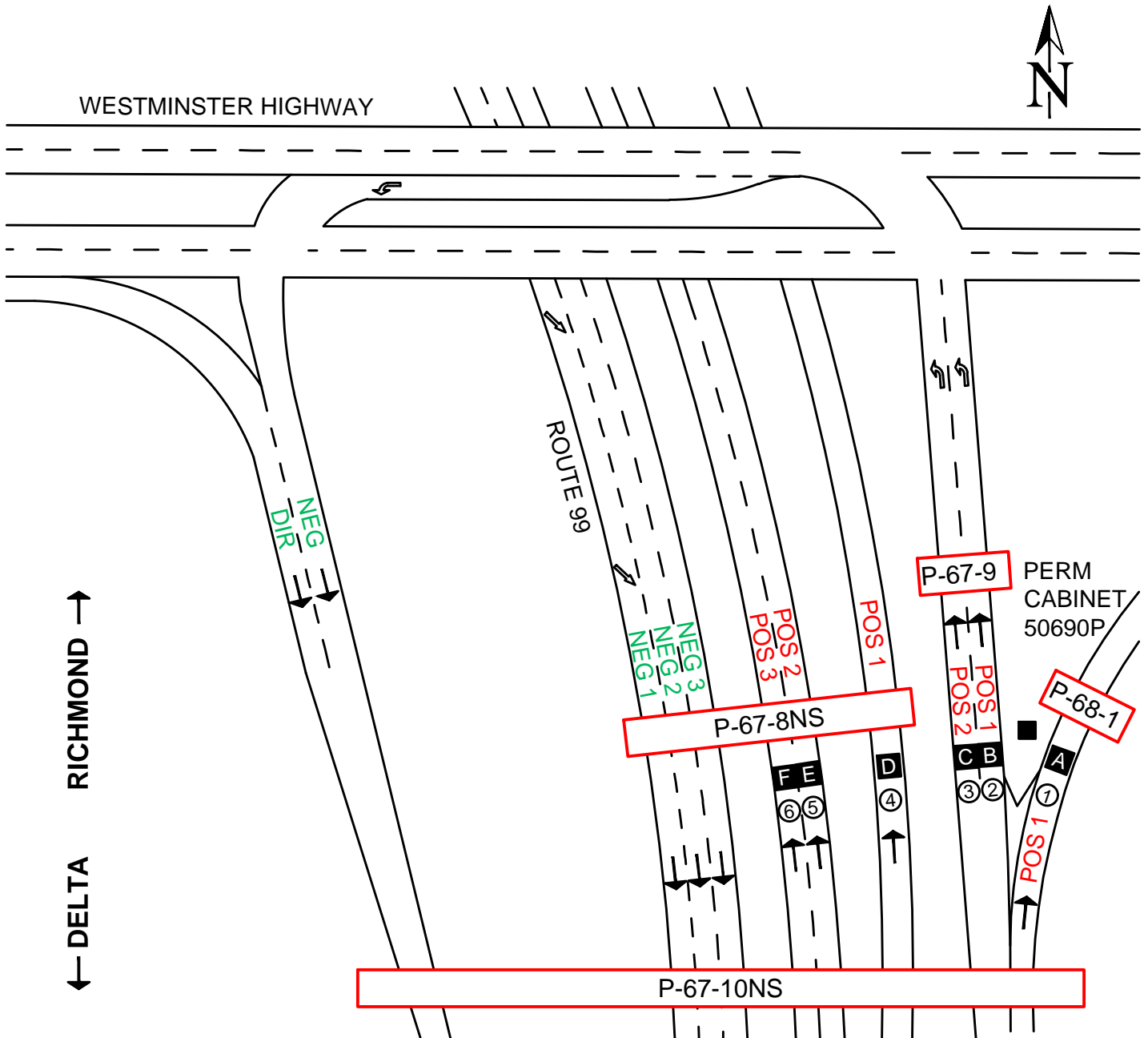

NOT TO SCALE

Highway Planning Branch  
TRANHighway Planning@gov.bc.ca

Revised Date: June / 2021  
Version 1-A