

TM Site:

Description:

P-16-14NS

ROUTE 99, JUST NORTH OF ROUTE 10 AT THE MATTHEWS ROAD IC, DELTA

Station: 50490P

Name: MATTHEWS

Survey: 5049

▲ - Short Count Post

■ - Loops

■ - Cabinet

■ - Junction Box

□ - Traffic Measurement Site

① - Channels

A - Detectors

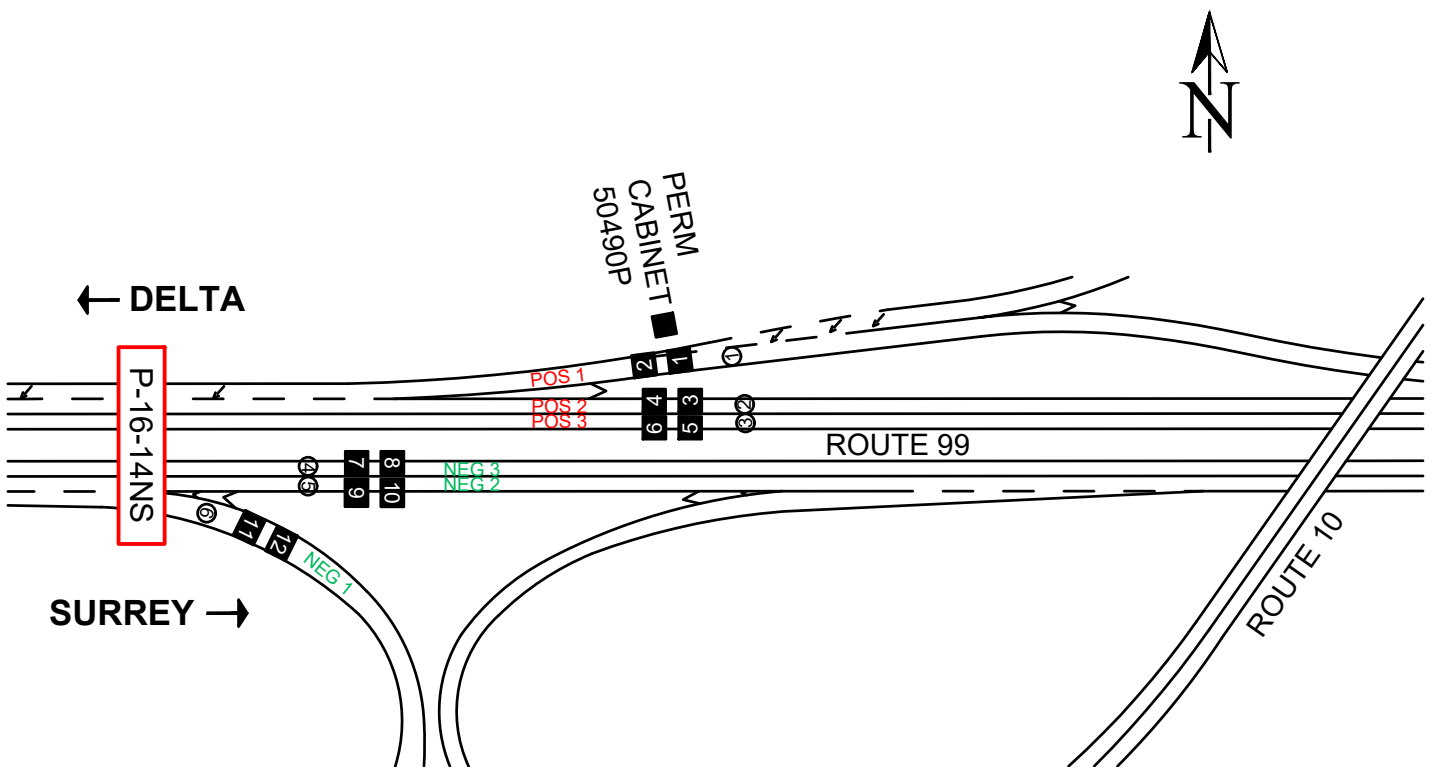

NOT TO SCALE

Highway Planning Branch
TRANHighway Planning@gov.bc.ca

Revised Date: May / 2023
Version 1-A