

TM Site:

Description:

16-060E

ROUTE 1, 0.5 KM WEST OF 176 STREET, SURREY (COMPOSITE 176 STREET I/C)

16-060W

ROUTE 1, 0.5 KM WEST OF 176 STREET, SURREY (COMPOSITE 176 STREET I/C)

Station: 50030S 50031S

50033S 50034S

Survey: 5003

▲ - Short Count Post

□ - TRADAS Traffic Measurement Site

■ - Loops

① - Channels

■ - Junction Box

A - Detectors

PHOTOLOG

YEAR: 1999

HIGHWAY: H1

IMAGE NUMBER: 20276

SHOWS LOOPS:

YES

NO

GPS: N 49.1816

W -122.7339

± 200 metres

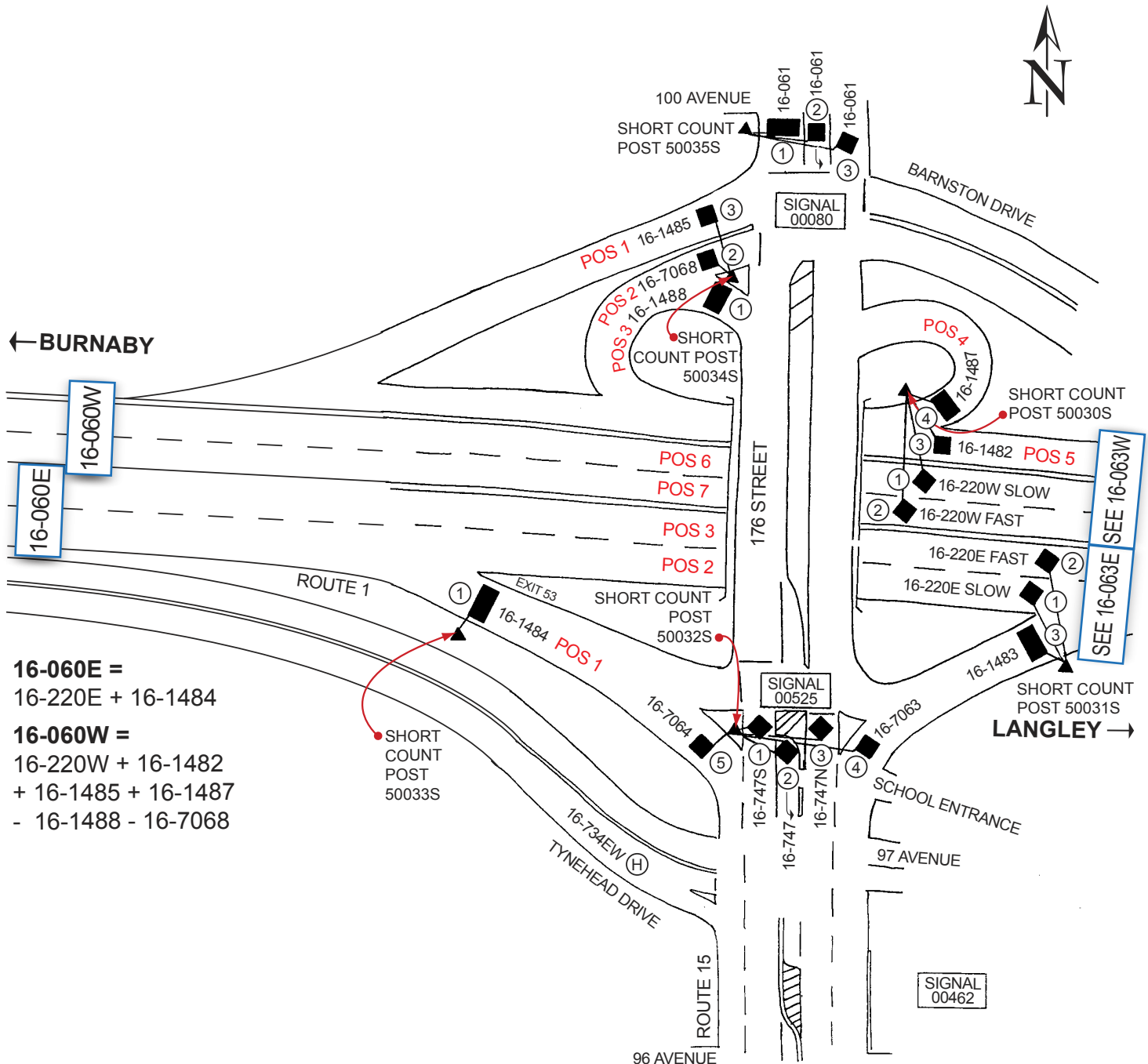

16-060E =
16-220E + 16-1484

16-060W =
16-220W + 16-1482
+ 16-1485 + 16-1487
- 16-1488 - 16-7068

NOT TO SCALE

Construction Maintenance Branch
TrafficDataProgram@gov.bc.ca

Revised Date: November / 2006
Version 2-A