

TM Site:

Description:

44-017NS

ROUTE 97, 600m SOUTH OF ROUTE 77

Station: 44017S

(HOSE)

Survey: -

▲ - Short Count Post

□ - TRADAS Traffic Measurement Site

■ - Loops

① - Channels

■ - Junction Box

A - Detectors

PHOTOLOG

YEAR: 2000

HIGHWAY: H97

IMAGE NUMBER: 88713

SHOWS LOOPS:

YES

NO

GPS: N 58.9015 W -121.1194

± 200m

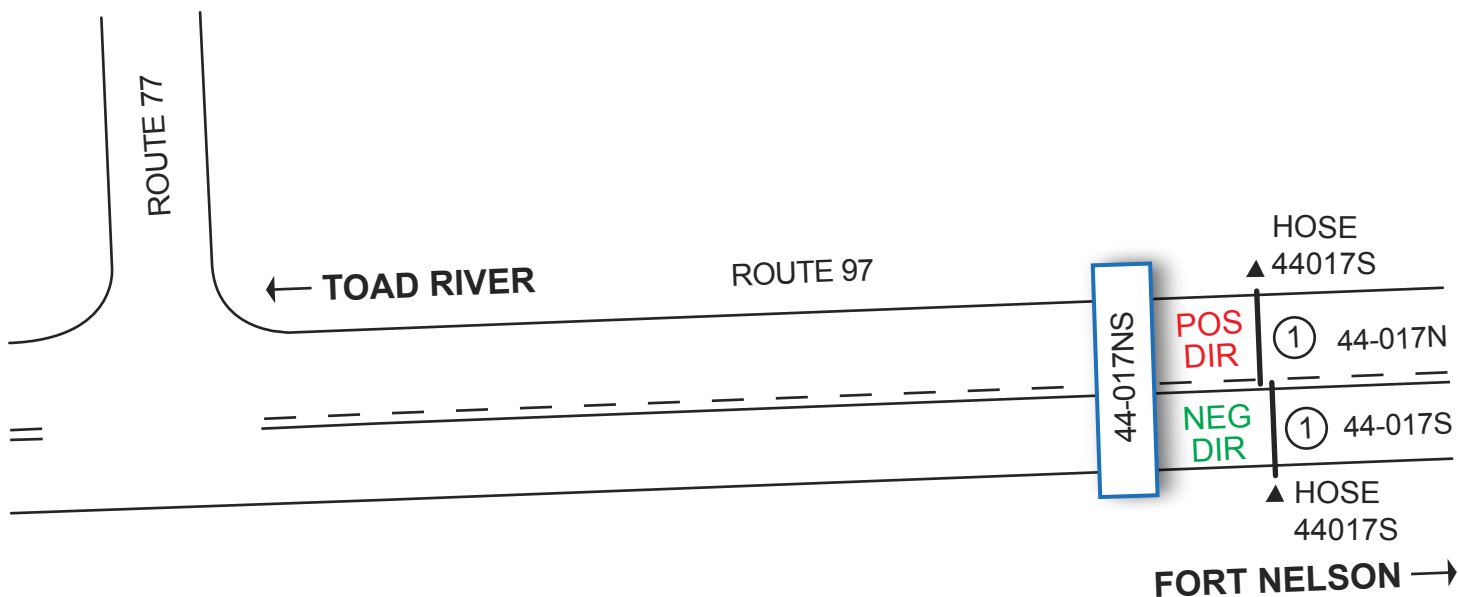

NOT TO SCALE

Construction Maintenance Branch
TrafficDataProgram@gov.bc.ca

Revised Date: March / 2006
Version 3-A